

Timed Toggle Protocol (TTP) Instructions



What is "TTP"?

TTP is Timed Toggle Protocol. It's a technology developed and refined by Lumitec which enables sophisticated features like dimming and/or color change with no external control boxes or specialized switches. The light is installed like any 12 or 24VDC light: using a positive and negative power wire controlled by any standard ON/OFF switch.

To Dim TTP-Equipped lights

Lumitec Lights with dimming functionality ramp up in intensity over a period of about 4 seconds when initially turned on. A brief "Off/On" toggle of the switch during the ramp phase will interrupt the ramp and hold the light at that intensity. If the light is already on then turn the switch off and repeat steps 1 & 2.

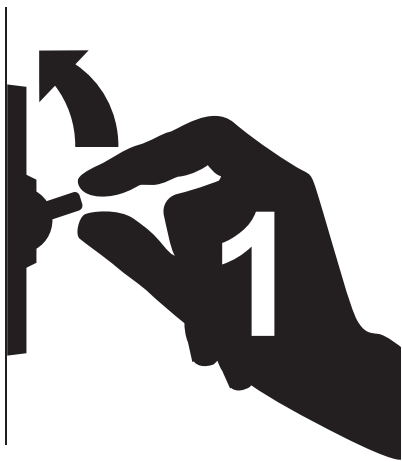

Turn Switch to "On" position.

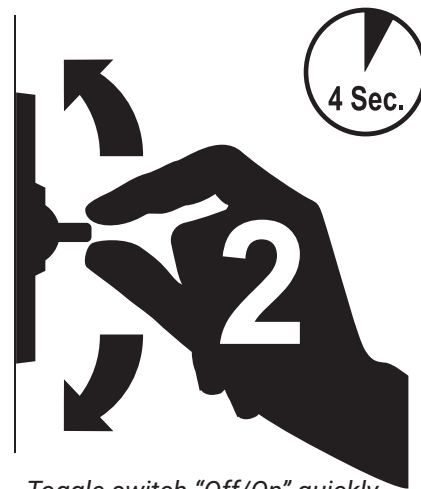

Toggle switch "Off/On" quickly during the 4 second ramp up period to set light intensity.

To change colors or change output modes of TTP-Equipped lights:

Multi-color or multi-output lights may incorporate Lumitec's TTP technology. To change the output color or output mode of a light, briefly toggle the light OFF then immediately back ON. The light will cycle to the alternate or next output color.

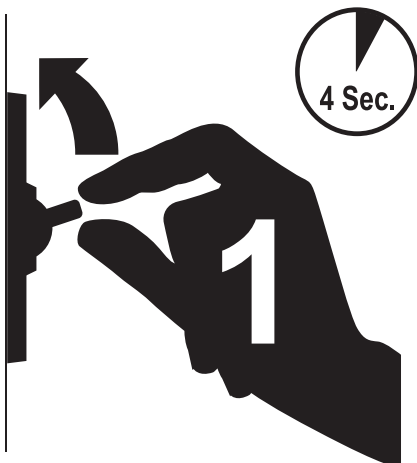

Turn Switch to "On" position and wait for four seconds until the light ramps up to full intensity.

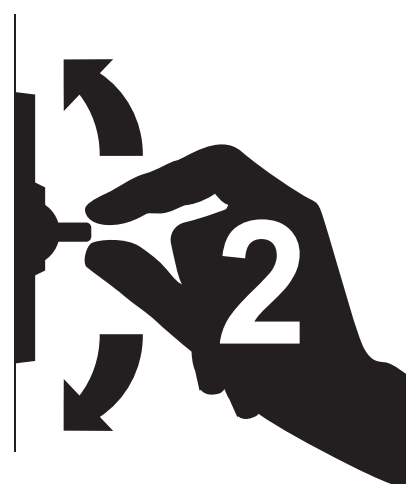

Toggle switch "Off/On" quickly to change modes. Once for each mode.